



Shri Vile Parle Kelavani Mandal's  
**Institute of Technology, Dhule**

Survey No. 499, Plot No. 02, Behind Gurudwara, Mumbai - Agra Road,  
Dist. Dhule, Maharashtra, 424001 Phone No.: (02562) 297801, 297601

Web: - svkm-iot.ac.in Mail: - iotdhule@svkm.ac.in

Approved By AICTE, DTE & Affiliated to DBATU, Lonere

7.1.2: The institution has facilities and initiatives for

**Index**

Sr. no.	Particulars	Page no
1.	Management of the various types of degradable and non-degradable waste	1-25



  
Dr. Nilesh Satunke  
**Principal**  
SVKM's Institute of Technology, Dhule



Shri Vile Parle Kelavani Mandal's  
**Institute of Technology, Dhule**

Survey No. 499, Plot No. 02, Behind Gurudwara, Mumbai - Agra Road,  
Dist. Dhule, Maharashtra, 424001 Phone No.: (02562) 297801, 297601

Web: - [svkm-iot.ac.in](http://svkm-iot.ac.in) Mail: - [iotdhule@svkm.ac.in](mailto:iotdhule@svkm.ac.in)

Approved By AICTE, DTE & Affiliated to DBATU, Lonere

---

## 2. Management of the various types of degradable and non-degradable waste

### Waste management at campus:

Waste is a clear contaminant that contributes to landfills and poisons that impair the earth's soil and environment. Because SVKM'S IOT is concerned about the environment, it actively encourages this knowledge among its students and staff by emphasizing cleanliness and hygiene on campus. Garbage is managed through a systematic procedure in which waste is separated into biodegradable and non-biodegradable wastes, as well as toxic and non-toxic wastes, and properly disposed of in laboratories. The exam section saves no longer-in-use papers and shreds them at regular intervals during the academic year. The SVKM'S IOT NSS team aggressively promotes waste management awareness through seminars and verbal campaigns.

Management of liquid waste, solid waste, and electronic waste are all practises at the institute. The college has a well-defined trash disposal mechanism and uses the following measures to educate students and staff about it:

#### I) Solid waste management:

The Institute follows best management practices for managing solid waste on campus. At the point of generation, the rubbish collected is divided. Separate trash cans for dry and moist waste are located in each corner of the hallway, restrooms, and common area. Additionally, dry trash bins can be found in libraries, classrooms, and laboratories. The municipal waste collection company collects and treats the wet and dry trash.

The examination section employs a number of creative tactics, such as the usage of one-sided papers for the seating chart and notice board work. The examining section will plan performs paper shredding after five years. Old publications, used papers and journal files, workshop scrap, and other materials are given to outside organizations for recycling.





Shri Vile Parle Kelavani Mandal's  
**Institute of Technology, Dhule**

Survey No. 499, Plot No. 02, Behind Gurudwara, Mumbai - Agra Road,  
Dist. Dhule, Maharashtra, 424001 Phone No.: (02562) 297801, 297601

Web: - [svkm-iot.ac.in](http://svkm-iot.ac.in) Mail: - [iotdhule@svkm.ac.in](mailto:iotdhule@svkm.ac.in)

Approved By AICTE, DTE & Affiliated to DBATU, Lonere



Solid and Bio Waste collection dustbin available at every floor of institute building

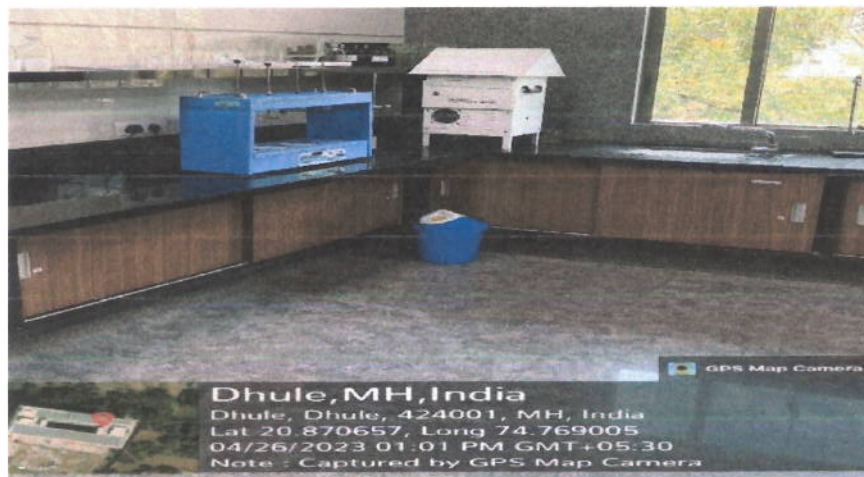

Solid Waste collection dustbin available at every floor lab of institute building

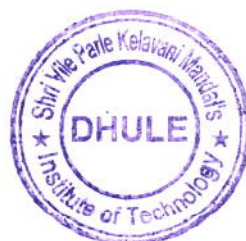



**Shri Vile Parle Kelavani Mandal's  
Institute of Technology, Dhule**

Survey No. 499, Plot No. 02, Behind Gurudwara, Mumbai - Agra Road,  
Dist. Dhule, Maharashtra, 424001 Phone No.: (02562) 297801, 297601

Web: - [svkm-iot.ac.in](http://svkm-iot.ac.in) Mail: - [iotdhule@svkm.ac.in](mailto:iotdhule@svkm.ac.in)  
Approved By AICTE, DTE & Affiliated to DBATU, Lonere



Currently, the college is storing every exam sheet and submission made by every student while their third batch of programmed graduates.

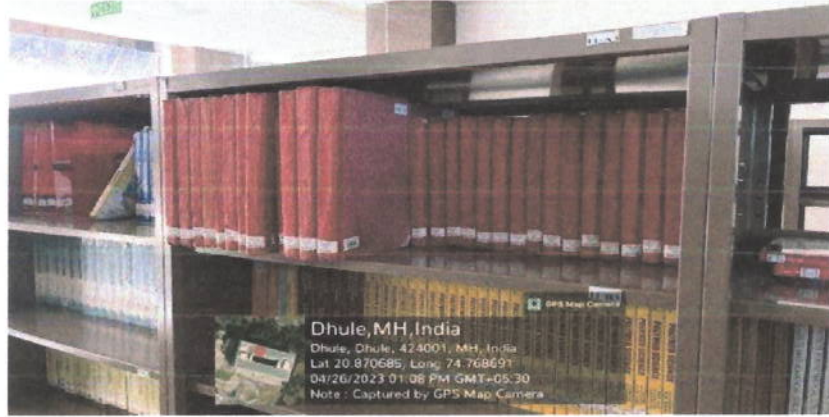

Rebinding books in the library of a college helps minimise solid waste





**Shri Vile Parle Kelavani Mandal's  
Institute of Technology**

Survey No.499, Plot No.02, Behind Gurudwara, Mumbai-Agra Road,  
Dist. Dhule, Maharashtra.424001

Date: - 08/01/2021

To,  
The Principal  
SVKM Institute of Technology  
Dhule-424001.

**Sub: - Regarding binding of library books for Institute of  
Technology, Dhule...**

Respected Sir,

With reference to above subject, we need to bind books of Library in  
SVKM's Institute of Technology, Dhule. Quantity is mentioned below.

Sr. No	Particulars	Size	Qty	Rate Per Qty	Amount
1	Library Books Bind	A4(Large)	42	130	5460
		A4(Small)	08	110	880
<b>Total</b>					<b>6340</b>

Kindly request you to approve the same.

Thanking you.

Yours sincerely,

*Khairnar*  
Mr. Atul Khairnar  
SVKM's IOT, Dhule.

*ok*  
*SP Bahadur*

Encl: - 1) Comparative Chart of Quotations  
2) Quotations received from vendors



Scanned with CamScanner



**Shri Vile Parle Kelavani Mandal's**

SVKM'S Institute of Technology, Dhule

Mumbai-Agra Highway, Dist. Dhule, Maharashtra, 424005

Phone No.:(02562) 297801

Date-08/01/2021

Comparative analysis of Vendor											
		Rashmi Printing Press Shriram Shopping Complex Sakri Road, Dhule - 424001			D. R. Shevgekar Book Binder Warkhedi Road, Subhash Nagar Dhule.			Subhash Book Binding Works 4, Lonthe Complex, Opp. Shriram Complex, Sakri Road Dhule.			
Sr. No.	PARTICULARS (JOB DETAILS)	Qty	Size	Rate per qty	Amount	Size	Rate per qty	Amount	Size	Rate per qty	Amount
1	Library Book Binding	42	A4(Large)	140	5880	A4(Large)	150	6300	A4(Large)	130	5460
		8	A4(Small)	130	1040	A4(Small)	135	1080	A4(Small)	110	880
	<b>Total</b>				6920			7380			6340
	Transportation/Loading Charge				0		18%	0		18%	0
	(+ )GST				6920			7380			6340
	<b>Total Amount</b>				NA			NA			NA
	Terms And Condition				Excluding			Excluding			Excluding
	Transportation / Loading Unloading Payment				After delivery			After delivery			After delivery

*Signature*



॥ ॐ साई ॥

फोन: 9665544221

# सुभाष बुक बाईडिंग वर्क्स

आमच्याकडे जुने सव्हीस बुक, लेबिनेशन करून बाईडिंग केले जाते.  
सर्वेच सर्व प्रकारचे रजिस्टर बुक, नकाशे यलाय बाईडिंग करून मिळेल.  
२० सोमेरी अक्षरात बाय हाकून मिळेल. २०

४. लोडे कॉम्प्लेक्स, श्रीराम कॉम्प्लेक्स समोर, साकी रोड, धुळे.

श्री. प्र. सुभाष बाईडिंग वर्क्स

धुळे

विल. नं. 1010

तारीख - 07/02/21

क्र.	विवरण	मा.	दर	एवढे
०१	साधी बाईडिंग मोठी साईज	३६	१३०	४६८० - ०
			एवढे -	४६८० - ०

टिप: बाईडिंग केलेले नवीन सव्हीस बुक मिळेल.

*[Signature]*  
माल मॅनेज्मन्टाची सही



*[Signature]*  
सुभाष बुक बाईडिंग वर्क्स  
प्रो. विस्व एस. भावसार

श्री. वि. पाठशाला

फोन: 9685544221

### सुभाष कुल वाईडिंग कार्यालय

आपण आपले पुणे शहरी स. यु.क. वीगिनेशन कार्यालय वाईडिंग केले जवळी  
समीच सर्व प्रकारचे सॉफ्टवेर युक्त, अकारो कलॅन्डर वाईडिंग करून मिळेल.  
हे सोलेरी अकारोत बांध घेऊन मिळेल. हे

प. ज्योति लॉन्गलेवरा, श्रीराय लॉन्गलेवरा समोर, शाहरी रोड, धुळे.

श्री. वि. पाठशाला  
धुळे

विलेन 10/11

तारीख: 08/08/21

अ.न.	तपविल	नाम	रक	रुपये
3	शाहरी वाईडिंग नवीन साईट	LP	770	6600-
			एकूण -	6600-00

टिप: वाईडिंग केलेले नवीन शहरी स युक्त मिळेल.

Chaitanya  
मालशेणा न्याची सही



सुभाष कुल वाईडिंग कार्यालय  
फोन: 9685544221





**Shri Vile Parle Kelavani Mandal's  
Institute of Technology, Dhule**

Survey No. 499, Plot No. 02, Behind Gurudwara, Mumbai - Agra Road,  
Dist. Dhule, Maharashtra, 424001 Phone No.: (02562) 297801, 297601

Web: - [svkm-iot.ac.in](http://svkm-iot.ac.in) Mail: - [iotdhule@svkm.ac.in](mailto:iotdhule@svkm.ac.in)

Approved By AICTE, DTE & Affiliated to DBATU, Lonere



Canteen food waste is collected separately

**Steps of Solid waste management**

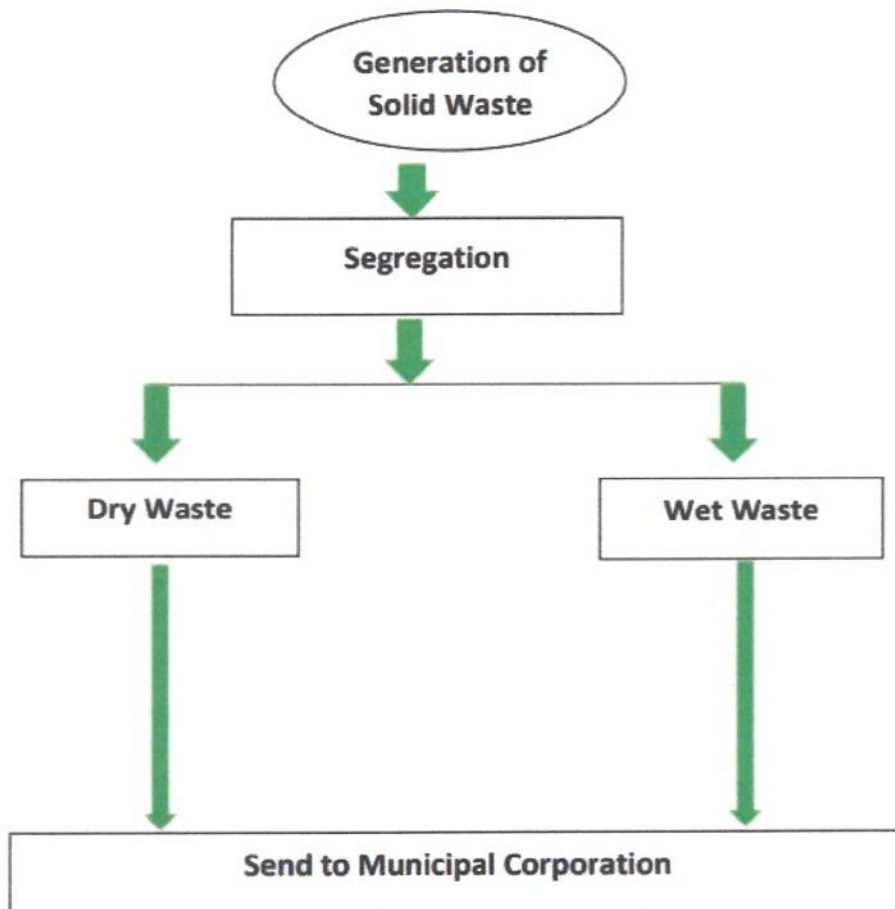



**Shri Vile Parle Kelavani Mandal's  
Institute of Technology, Dhule**

Survey No. 499, Plot No. 02, Behind Gurudwara, Mumbai - Agra Road,  
Dist. Dhule, Maharashtra, 424001 Phone No.: (02562) 297801, 297601

Web: - [svkm-iot.ac.in](http://svkm-iot.ac.in) Mail: - [iotdhule@svkm.ac.in](mailto:iotdhule@svkm.ac.in)  
Approved By AICTE, DTE & Affiliated to DBATU, Lonere

Sl. No.	Name	Address	Phone No.	Vehicle	Time	Remarks
07	Nishwalekarma stone m... Dhule	MCA-2639	1718-18-1188	Tractor	11:50	Shilpa - cement
08	Shilpa - cement			Tractor	11:50	Shilpa - cement
Date: 15/05/2023						
01	Kunal Basari sir	Dhule	MH-18-BG-11879	Tractor	8:40	S.O.C. - 2000
02	Nishwalekarma stone m... Dhule	MCA-2639	1718-18-1188	Tractor	11:50	Shilpa - cement
03	Mana Nagar Public	Dhule	MH-18-BG-3475	Van	10:40	Shilpa - cement
04	Shilpa - cement			Tractor	11:50	Shilpa - cement
05	Nishwalekarma stone m... Dhule	MCA-2639	1718-18-1188	Tractor	11:50	Shilpa - cement
06	Shilpa - cement			Tractor	11:50	Shilpa - cement
07	Nishwalekarma stone m... Dhule	MCA-2639	1718-18-1188	Tractor	11:50	Shilpa - cement
08	Nishwalekarma stone m... Dhule	MCA-2639	1718-18-1188	Tractor	11:50	Shilpa - cement
Date: 15/05/2023						
01	Kunal Basari sir	Dhule	MH-18-BG-11879	Tractor	8:40	S.O.C. - 2000
02	Nishwalekarma stone m... Dhule	MCA-2639	1718-18-1188	Tractor	11:50	Shilpa - cement
03	Mana Nagar Public	Dhule	MH-18-BG-3475	Van	10:40	Shilpa - cement
04	Shilpa - cement			Tractor	11:50	Shilpa - cement
05	Nishwalekarma stone m... Dhule	MCA-2639	1718-18-1188	Tractor	11:50	Shilpa - cement
06	Shilpa - cement			Tractor	11:50	Shilpa - cement
07	Nishwalekarma stone m... Dhule	MCA-2639	1718-18-1188	Tractor	11:50	Shilpa - cement
08	Nishwalekarma stone m... Dhule	MCA-2639	1718-18-1188	Tractor	11:50	Shilpa - cement

Entry muster Photo of Dhule Municipal Corporation bell truck entry

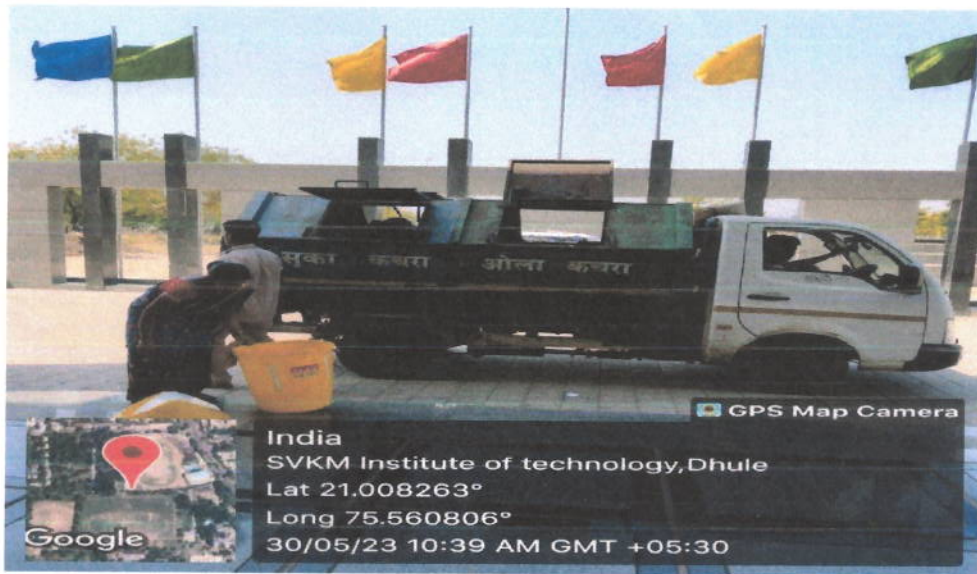

Photo of Dhule Municipal Corporation bell truck collect the all solid waste





Shri Vile Parle Kelavani Mandal's  
**Institute of Technology, Dhule**

Survey No. 499, Plot No. 02, Behind Gurudwara, Mumbai - Agra Road,  
Dist. Dhule, Maharashtra, 424001 Phone No.: (02562) 297801, 297601

Web: - [svkm-iot.ac.in](http://svkm-iot.ac.in) Mail: - [iotdhule@svkm.ac.in](mailto:iotdhule@svkm.ac.in)

Approved By AICTE, DTE & Affiliated to DBATU, Lonere

**II) E-waste management:**

Since the institution is very new, no particular type of E-waste has been produced, but various sorts of electronic gadgets are being developed and marketed as a result of technological advancements. After a few months or years, these products become obsolete. Because these goods include hazardous compounds such as lithium, lead, zinc, and other metals, incorrect disposal of these products is hazardous to living things. As a result, E-waste management is a critical issue. E-waste management comprises gathering all electronic garbage produced on campus, keeping it in a centralized area, and recycling it. The college promotes the old PC Replacement activity and provide old PC for personal use to employees with minimum cost its help to E-waste management

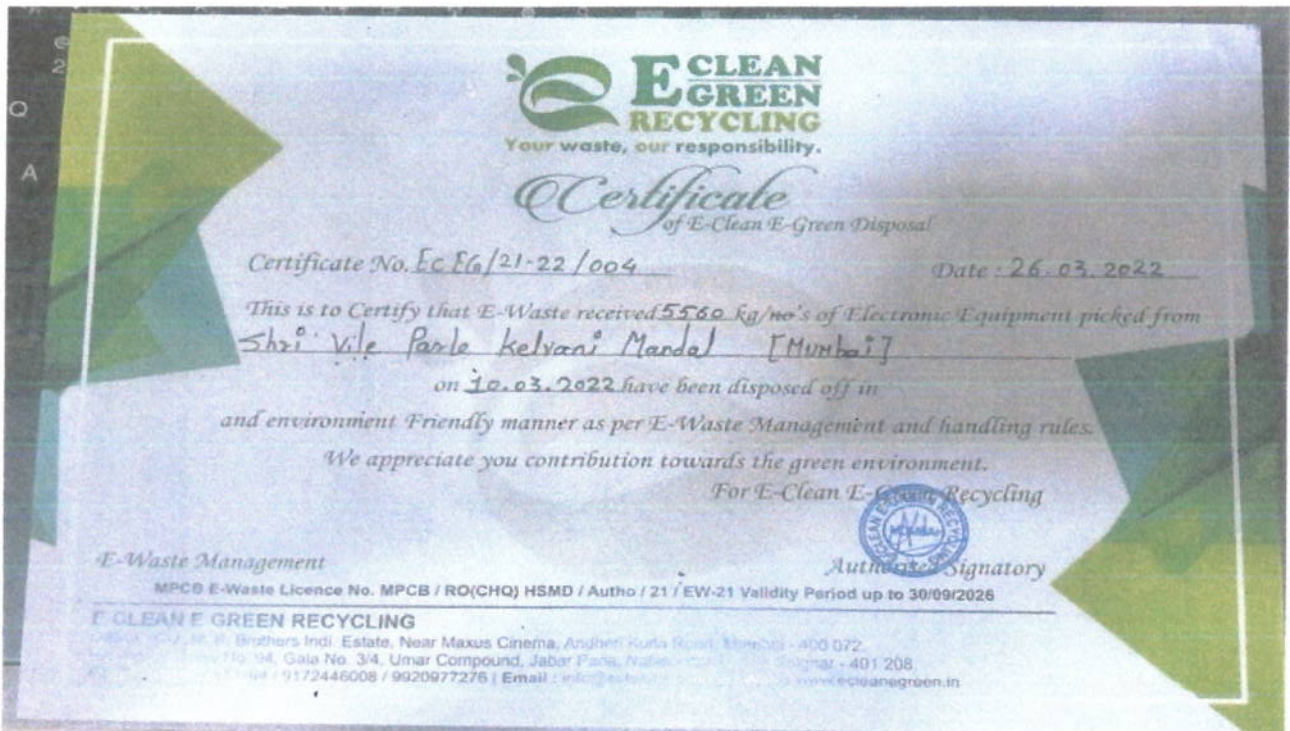

Photo of E-waste Collection certificate





**Shri Vile Parle Kelavani Mandal's  
Institute of Technology, Dhule**

Survey No. 499, Plot No. 02, Behind Gurudwara, Mumbai - Agra Road,  
Dist. Dhule, Maharashtra, 424001 Phone No.: (02562) 297801, 297601

Web: - [svkm-iot.ac.in](http://svkm-iot.ac.in) Mail: - [iotdhule@svkm.ac.in](mailto:iotdhule@svkm.ac.in)

Approved By AICTE, DTE & Affiliated to DBATU, Lonere



Photo of E-waste Collection





**Shri Vile Parle Kelavani Mandal's  
Institute of Technology, Dhule**

Survey No. 499, Plot No. 02, Behind Gurudwara, Mumbai - Agra Road,  
Dist. Dhule, Maharashtra, 424001 Phone No.: (02562) 297801, 297601

Web: - [svkm-iot.ac.in](http://svkm-iot.ac.in) Mail: - [iotdhule@svkm.ac.in](mailto:iotdhule@svkm.ac.in)  
Approved By AICTE, DTE & Affiliated to DBATU, Lonere

**III) Liquid waste management:**

**1. Treated in septic tank**

The municipal sewer open drain is currently being used to convey liquid waste from the toilets despite. Bathroom trash, frequent washing and mopping, canteen waste water, and waste water are all examples of liquid waste is treated in septic tank then discharge to municipal sewer open drain.

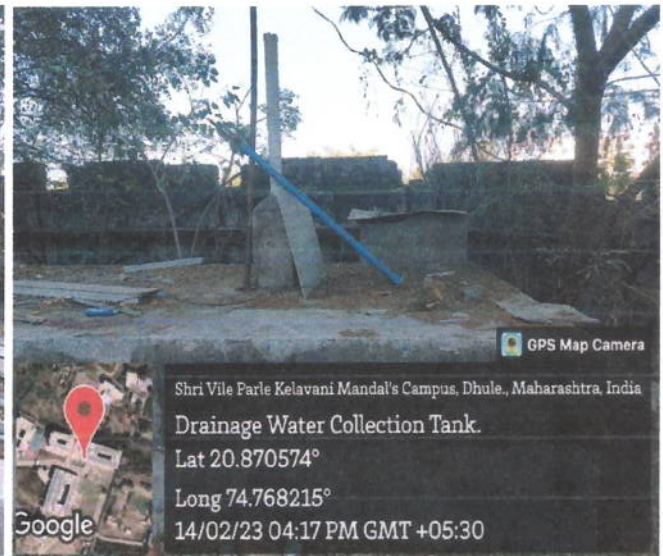

Photo of the Septic tank



Photo of liquid waste discharge in municipal sewer open drain





Shri Vile Parle Kelavani Mandal's  
**Institute of Technology, Dhule**

Survey No. 499, Plot No. 02, Behind Gurudwara, Mumbai - Agra Road,  
Dist. Dhule, Maharashtra, 424001 Phone No.: (02562) 297801, 297601

Web: - [svkm-iot.ac.in](http://svkm-iot.ac.in) Mail: - [iotdhule@svkm.ac.in](mailto:iotdhule@svkm.ac.in)

Approved By AICTE, DTE & Affiliated to DBATU, Lonere



**CERTIFICATE FOR SEWAGE DISPOSAL FACILITY**

This is to certify that Sewage Disposal Facility is available with Shri Vile Parle Kelavani Mandal's new proposed institution, namely **Shri Vile Parle Kelavani Mandal's Institute of Technology, Dhule**, situated at site land Survey No. 499, Plot No 02, Behind Gurudwara, Mumbai Agra Highway, Dhule- 424 001, with waste collected from toilet blocks and urinals, properly treated with septic tank and disposal through soak pit.

This Certificate is provided with the reference to institute request.

Date : 23/03/2023  
Place : Dhule

Signature of the Architect  
Name of the Architect : Mr. Bijal Doshi  
Registration No. : CA/90/13453  
Date : 23/03/2023  
Place : Dhule  
Seal/ Stamp of the Architect

  
**Bijal Doshi**  
CA / 90 / 13453



ADDRESS : 19 SATNAM SAGAR, 20 PEDDER ROAD, MUMBAI - 400026  
CONTACT : 9820064108 EMAIL ID : [bijaldoshi67@gmail.com](mailto:bijaldoshi67@gmail.com)  
[www.bijaldoshiarchitects.com](http://www.bijaldoshiarchitects.com)  Bijal Doshi  [architectbijaldoshi](https://www.instagram.com/architectbijaldoshi)

Photo of certificate for sewage disposal facility





**Shri Vile Parle Kelavani Mandal's  
Institute of Technology, Dhule**

Survey No. 499, Plot No. 02, Behind Gurudwara, Mumbai - Agra Road,  
Dist. Dhule, Maharashtra, 424001 Phone No.: (02562) 297801, 297601

Web: - [svkm-iot.ac.in](http://svkm-iot.ac.in) Mail: - [iotdhule@svkm.ac.in](mailto:iotdhule@svkm.ac.in)  
Approved By AICTE, DTE & Affiliated to DBATU, Lonere

**2.Treated in Sludge treatment plant**

College encourages water conservation so that the sludge treatment facility present in campus, so the proof is attached Such as photo of STP and PO order of machine

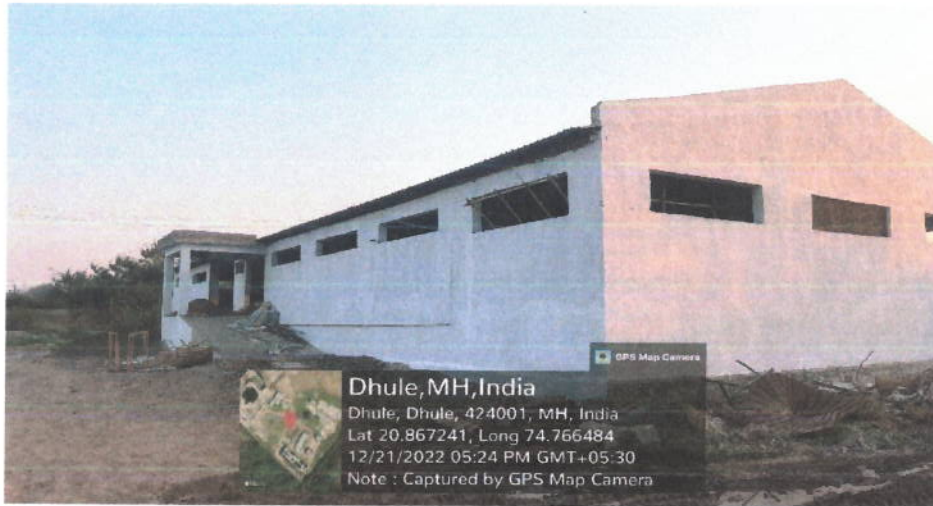
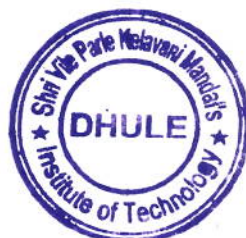

Photo of Sludge treatment plant in college campus



Photo of inside Sludge treatment plant in college campus



KEY PLAN (NOT TO SCALE)

- GENERAL NOTES:
1. This plan is for reference only. It is not to be used for construction.
  2. All levels are given in meters above Mean Sea Level (MSL).
  3. The plan is for reference only. It is not to be used for construction.
  4. All levels and dimensions are in meters.
  5. All levels are given in meters above Mean Sea Level (MSL).
  6. All levels are given in meters above Mean Sea Level (MSL).

SYMBOL	MATERIAL	SPECIFICATIONS
[Symbol]	FLOORING 1	
[Symbol]	FLOORING 2	
[Symbol]	FLOORING 3	
[Symbol]	WALL CLADDING	
[Symbol]	RAIL COVERT	
[Symbol]	LAINT	
[Symbol]	PREPARED FLOORING	
[Symbol]	MECHANICAL CHASIS	
[Symbol]	WATER	

LEGEND:

1. NORTH

2. EAST

3. SOUTH

4. WEST

DATE	NO.	BY	CHKD.	APPD.	REV.	DATE	NO.	BY	CHKD.	APPD.	REV.

PROJECT TITLE: SHRI VILE PARLE KETAYANI MENDALS INSTITUTE

DRAWING TITLE: CAMPUS MASTER PLAN

SCALE: 1:1000

DATE: 15/08/2023

DESIGN NO: 22/08/2023

REV NO: 01

**BEYOND GREEN**

Landscaper Architecture & Interiors

101, 102, 103, 104, 105, 106, 107, 108, 109, 110, 111, 112, 113, 114, 115, 116, 117, 118, 119, 120, 121, 122, 123, 124, 125, 126, 127, 128, 129, 130, 131, 132, 133, 134, 135, 136, 137, 138, 139, 140, 141, 142, 143, 144, 145, 146, 147, 148, 149, 150, 151, 152, 153, 154, 155, 156, 157, 158, 159, 160, 161, 162, 163, 164, 165, 166, 167, 168, 169, 170, 171, 172, 173, 174, 175, 176, 177, 178, 179, 180, 181, 182, 183, 184, 185, 186, 187, 188, 189, 190, 191, 192, 193, 194, 195, 196, 197, 198, 199, 200, 201, 202, 203, 204, 205, 206, 207, 208, 209, 210, 211, 212, 213, 214, 215, 216, 217, 218, 219, 220, 221, 222, 223, 224, 225, 226, 227, 228, 229, 230, 231, 232, 233, 234, 235, 236, 237, 238, 239, 240, 241, 242, 243, 244, 245, 246, 247, 248, 249, 250, 251, 252, 253, 254, 255, 256, 257, 258, 259, 260, 261, 262, 263, 264, 265, 266, 267, 268, 269, 270, 271, 272, 273, 274, 275, 276, 277, 278, 279, 280, 281, 282, 283, 284, 285, 286, 287, 288, 289, 290, 291, 292, 293, 294, 295, 296, 297, 298, 299, 300, 301, 302, 303, 304, 305, 306, 307, 308, 309, 310, 311, 312, 313, 314, 315, 316, 317, 318, 319, 320, 321, 322, 323, 324, 325, 326, 327, 328, 329, 330, 331, 332, 333, 334, 335, 336, 337, 338, 339, 340, 341, 342, 343, 344, 345, 346, 347, 348, 349, 350, 351, 352, 353, 354, 355, 356, 357, 358, 359, 360, 361, 362, 363, 364, 365, 366, 367, 368, 369, 370, 371, 372, 373, 374, 375, 376, 377, 378, 379, 380, 381, 382, 383, 384, 385, 386, 387, 388, 389, 390, 391, 392, 393, 394, 395, 396, 397, 398, 399, 400, 401, 402, 403, 404, 405, 406, 407, 408, 409, 410, 411, 412, 413, 414, 415, 416, 417, 418, 419, 420, 421, 422, 423, 424, 425, 426, 427, 428, 429, 430, 431, 432, 433, 434, 435, 436, 437, 438, 439, 440, 441, 442, 443, 444, 445, 446, 447, 448, 449, 450, 451, 452, 453, 454, 455, 456, 457, 458, 459, 460, 461, 462, 463, 464, 465, 466, 467, 468, 469, 470, 471, 472, 473, 474, 475, 476, 477, 478, 479, 480, 481, 482, 483, 484, 485, 486, 487, 488, 489, 490, 491, 492, 493, 494, 495, 496, 497, 498, 499, 500, 501, 502, 503, 504, 505, 506, 507, 508, 509, 510, 511, 512, 513, 514, 515, 516, 517, 518, 519, 520, 521, 522, 523, 524, 525, 526, 527, 528, 529, 530, 531, 532, 533, 534, 535, 536, 537, 538, 539, 540, 541, 542, 543, 544, 545, 546, 547, 548, 549, 550, 551, 552, 553, 554, 555, 556, 557, 558, 559, 560, 561, 562, 563, 564, 565, 566, 567, 568, 569, 570, 571, 572, 573, 574, 575, 576, 577, 578, 579, 580, 581, 582, 583, 584, 585, 586, 587, 588, 589, 590, 591, 592, 593, 594, 595, 596, 597, 598, 599, 600, 601, 602, 603, 604, 605, 606, 607, 608, 609, 610, 611, 612, 613, 614, 615, 616, 617, 618, 619, 620, 621, 622, 623, 624, 625, 626, 627, 628, 629, 630, 631, 632, 633, 634, 635, 636, 637, 638, 639, 640, 641, 642, 643, 644, 645, 646, 647, 648, 649, 650, 651, 652, 653, 654, 655, 656, 657, 658, 659, 660, 661, 662, 663, 664, 665, 666, 667, 668, 669, 670, 671, 672, 673, 674, 675, 676, 677, 678, 679, 680, 681, 682, 683, 684, 685, 686, 687, 688, 689, 690, 691, 692, 693, 694, 695, 696, 697, 698, 699, 700, 701, 702, 703, 704, 705, 706, 707, 708, 709, 710, 711, 712, 713, 714, 715, 716, 717, 718, 719, 720, 721, 722, 723, 724, 725, 726, 727, 728, 729, 730, 731, 732, 733, 734, 735, 736, 737, 738, 739, 740, 741, 742, 743, 744, 745, 746, 747, 748, 749, 750, 751, 752, 753, 754, 755, 756, 757, 758, 759, 760, 761, 762, 763, 764, 765, 766, 767, 768, 769, 770, 771, 772, 773, 774, 775, 776, 777, 778, 779, 780, 781, 782, 783, 784, 785, 786, 787, 788, 789, 790, 791, 792, 793, 794, 795, 796, 797, 798, 799, 800, 801, 802, 803, 804, 805, 806, 807, 808, 809, 810, 811, 812, 813, 814, 815, 816, 817, 818, 819, 820, 821, 822, 823, 824, 825, 826, 827, 828, 829, 830, 831, 832, 833, 834, 835, 836, 837, 838, 839, 840, 841, 842, 843, 844, 845, 846, 847, 848, 849, 850, 851, 852, 853, 854, 855, 856, 857, 858, 859, 860, 861, 862, 863, 864, 865, 866, 867, 868, 869, 870, 871, 872, 873, 874, 875, 876, 877, 878, 879, 880, 881, 882, 883, 884, 885, 886, 887, 888, 889, 890, 891, 892, 893, 894, 895, 896, 897, 898, 899, 900, 901, 902, 903, 904, 905, 906, 907, 908, 909, 910, 911, 912, 913, 914, 915, 916, 917, 918, 919, 920, 921, 922, 923, 924, 925, 926, 927, 928, 929, 930, 931, 932, 933, 934, 935, 936, 937, 938, 939, 940, 941, 942, 943, 944, 945, 946, 947, 948, 949, 950, 951, 952, 953, 954, 955, 956, 957, 958, 959, 960, 961, 962, 963, 964, 965, 966, 967, 968, 969, 970, 971, 972, 973, 974, 975, 976, 977, 978, 979, 980, 981, 982, 983, 984, 985, 986, 987, 988, 989, 990, 991, 992, 993, 994, 995, 996, 997, 998, 999, 1000

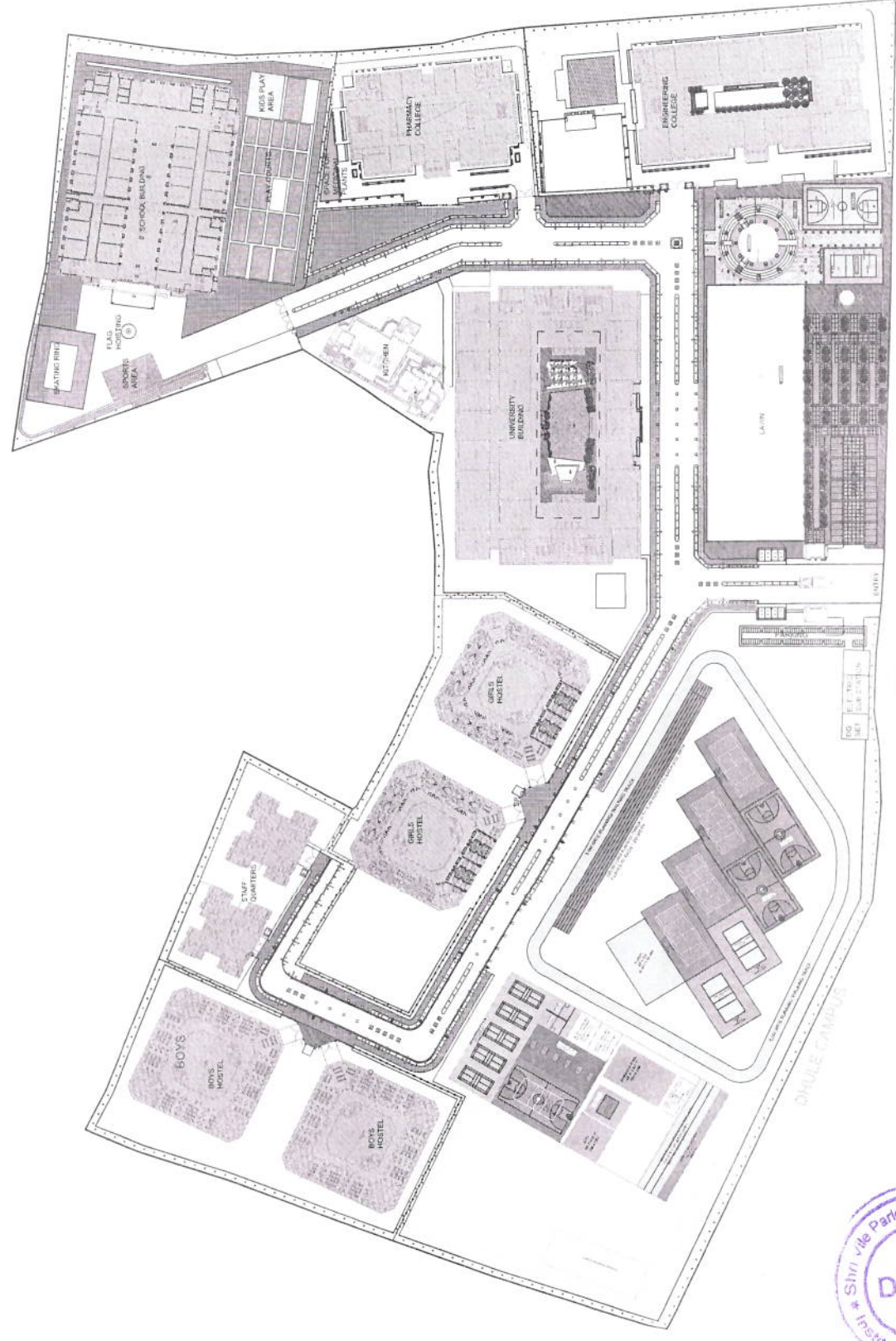





**PROJECT** : NHIMS CAMPUS  
DHULE

**CLIENT** : M/S SHRI VILE PARLE KELAVANI MANDAL

**CONSULTANT** : M/S ESKAYEM CONSULTANTS PVT LTD  
301, 3RD FLOOR, SWASTIK CHAMBERS,  
CHANDRANAGAR, DHULE,  
TELE: 025-252845/41/47

**ARCHITECT** : M/S TP ARCHITECTS

- NOTES**
1. WORKS TO BE FINISHED AT WORK DRAIN SUMP CENTER
  2. ALL DRAIN SUMP TO BE 600x600x900MM DEEP FROM TANK BOTTOM
  3. FLOOR ROOM DRAIN TO BE 200MM WITH X 200MM DEPTH
  4. ALL DRAIN SUMP TO BE 200MM WITH X 200MM DEPTH
  5. PLANT VENTILATION AND LIFTING TO BE DONE BY CLIENT
  6. ALL CIVIL WORKS FINISHING CUT-OFFS TO BE DONE BY CLIENT
  7. FF-FINISHED PLANT ROOM FLOOR LEVEL
  8. ALL WORKS TO BE DONE BY STRUCTURAL CONSULTANT

**NOTE TO STRUCTURAL CONSULTANT:**

1. ALL TANKS TO BE FINISHED BY THE CLIENT
2. ALL TANKS TO BE FINISHED BY THE CLIENT
3. ALL TANKS TO BE FINISHED BY THE CLIENT
4. ALL TANKS TO BE FINISHED BY THE CLIENT
5. ALL TANKS TO BE FINISHED BY THE CLIENT
6. ALL TANKS TO BE FINISHED BY THE CLIENT
7. ALL TANKS TO BE FINISHED BY THE CLIENT
8. ALL TANKS TO BE FINISHED BY THE CLIENT

REVISED AS PER UPDATED SECTIONS	DATE	BY
BY TPA VIA MAIL	02.11.19	VICKY
BY TPA VIA MAIL	02.11.19	VICKY
BY TPA VIA MAIL	02.11.19	VICKY
BY TPA VIA MAIL	02.11.19	VICKY
BY TPA VIA MAIL	02.11.19	VICKY
BY TPA VIA MAIL	02.11.19	VICKY
BY TPA VIA MAIL	02.11.19	VICKY
BY TPA VIA MAIL	02.11.19	VICKY
BY TPA VIA MAIL	02.11.19	VICKY
BY TPA VIA MAIL	02.11.19	VICKY

**PRABHU ENVIROTEC PRIVATE LIMITED.**  
215, NEW PAVLA ROAD, ANAND NAGAR CHASE ROAD,  
AURHAR (DIST. NASHIK) - 430 009

**TITLE** : SEWAGE TREATMENT PLANT ( 800 M<sup>3</sup>/DAY )  
TOP & BOTTOM LAYOUT

**DRAWING NO.** : PEPL/NHIMS DHULE/STP/19/358B/02

**SCALE** : DATE : CHECKED BY : DRAWN BY : REV

**M/S** : 06.05.19 : AGP : MAHENDRA : R6

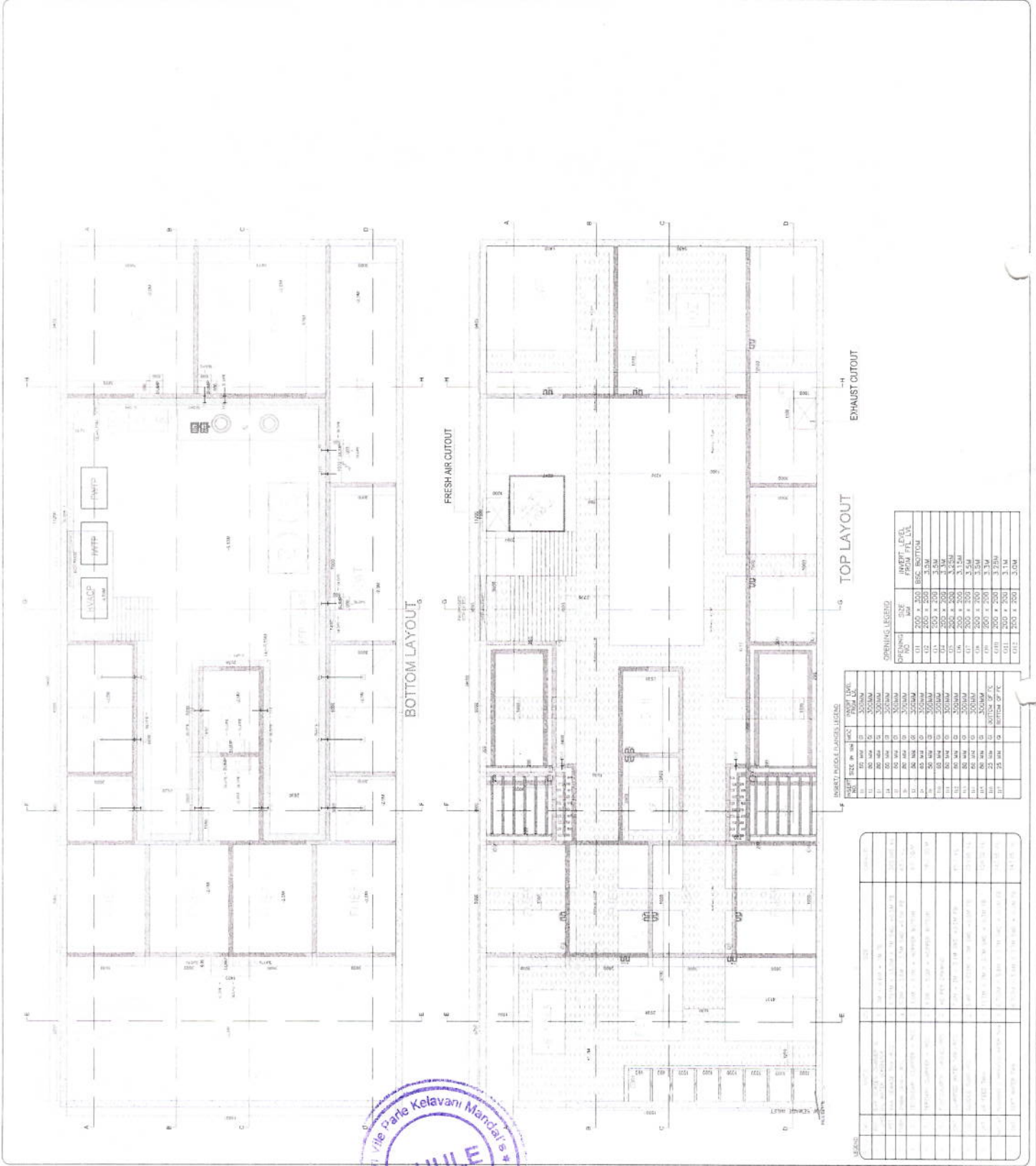

**INSERT SCHEDULE LEGEND**

NO.	SIZE (Ø x L)	TYPE	LEVEL
01	150 x 150	Manhole	FF
02	200 x 200	Manhole	FF
03	300 x 300	Manhole	FF
04	450 x 450	Manhole	FF
05	600 x 600	Manhole	FF
06	750 x 750	Manhole	FF
07	900 x 900	Manhole	FF
08	1050 x 1050	Manhole	FF
09	1200 x 1200	Manhole	FF
10	1350 x 1350	Manhole	FF
11	1500 x 1500	Manhole	FF
12	1650 x 1650	Manhole	FF
13	1800 x 1800	Manhole	FF
14	2000 x 2000	Manhole	FF
15	2250 x 2250	Manhole	FF
16	2500 x 2500	Manhole	FF
17	2750 x 2750	Manhole	FF
18	3000 x 3000	Manhole	FF
19	3250 x 3250	Manhole	FF
20	3500 x 3500	Manhole	FF

**LEGEND**

NO.	DESCRIPTION
01	Manhole
02	Manhole
03	Manhole
04	Manhole
05	Manhole
06	Manhole
07	Manhole
08	Manhole
09	Manhole
10	Manhole
11	Manhole
12	Manhole
13	Manhole
14	Manhole
15	Manhole
16	Manhole
17	Manhole
18	Manhole
19	Manhole
20	Manhole





**Shri Vile Parle Kelavani Mandal's**  
SVKM Central Office-Dhule  
SVKM's NMIMS  
Survey No. 499, Near Gurudwara,  
Behind Hotel Zankar Palace,  
Dhule 424001

Tel. No. : 022-42335166  
Fax No. :  
Email : florenca.dsouza@svkm.ac.in  
PAN No. : AABTS8228H  
GST No. : 27AABTS8228H1Z8

### Work Order

Page 1 of 5

<b>Vendor : 502671</b> PRABHU ENVIROTEC PVT LIMITED 213 / 218, New Apollo Estate Mogra Road Andheri (East) Mumbai 400069 Maharashtra Tel. No. : 022 - 28380534 GST No. : 27AAACP2328R1Z1	<b>PO No. : 8000003058</b> PO Date : 12.04.2019 Your Reference : Project : NMIMS University at Dhule WBS : S-D.01.02.04.05.09 Network : 5000100/0640	<b>Delivery Address :</b> Dhule University    <b>Total Amt : INR 7,552,000.00</b>
--	---	--

Dear Sir / Madam,  
Please provide the following services in accordance with terms and conditions printed in this PO.

Sr. No.	Item Code & Description	UOM	Qty	Rate(INR)	Disc.	Amt(INR)
1	<b>STP Work - SITC MBBR STP 600KLD</b>					
10	<b>Service No.</b> Perforated SS Screen with grease trap <b>SAC Code.</b> 9994	EA	1	23,000.00		23,000.00
						2,070.00
						2,070.00
20	<b>Service No.</b> Raw sewage pumps as per data sheet STP <b>SAC Code.</b> 9994	EA	3	93,000.00		279,000.00
						25,110.00
						25,110.00
30	<b>Service No.</b> Diffused aeration system - Equalisation <b>SAC Code.</b> 9994	LOT	1	800,000.00		800,000.00
						72,000.00
						72,000.00
40	<b>Service No.</b> MBBR Media <b>SAC Code.</b> 9994	LOT	1	625,000.00		625,000.00
						56,250.00
						56,250.00
50	<b>Service No.</b> Tube settlers for secondary clarifier <b>SAC Code.</b> 9994	LOT	1	120,000.00		120,000.00
						10,800.00
						10,800.00
60	<b>Service No.</b> Filter Feed Pumps as per data sheet STP <b>SAC Code.</b> 9994	EA	3	69,000.00		207,000.00
						18,630.00
						18,630.00



**Shri Vile Parle Kelavani Mandal's**

SVKM Central Office-Dhule

SVKM's NMIMS

Survey No. 499, Near Gurudwara,  
Behind Hotel Zankar Palace,  
Dhule 424001

Tel. No. : 022-42335166

Fax No. :

Email : florenzia.dsouza@svkm.ac.in

PAN No. : AABTS8228H

GST No. : 27AABTS8228H1Z8

**Work Order**

Page 2 of 5

<b>Vendor : 502671</b> PRABHU ENVIROTEC PVT LIMITED 213 / 218, New Apollo Estate Mogra Road Andheri (East) Mumbai 400069 Maharashtra Tel. No. : 022 - 28380534 GST No. : 27AAACP2328R1Z1	<b>PO No. : 8000003058</b> PO Date : 12.04.2019 Your Reference : Project : NMIMS University at Dhule WBS : S-D.01.02.04.05.09 Network : 5000100/0640	<b>Delivery Address :</b> Dhule University  <b>Total Amt : INR 7,552,000.00</b>
--	---	--

70	<b>Service No.</b> Pressure Sand Filter as per data sheet <b>SAC Code.</b> 9994	EA	1	300,000.00		300,000.00
					CGST @ 9 %	27,000.00
					SGST @ 9 %	27,000.00
80	<b>Service No.</b> Activated carbon Filter as per data sheet <b>SAC Code.</b> 9994	EA	1	310,000.00		310,000.00
					CGST @ 9 %	27,900.00
					SGST @ 9 %	27,900.00
90	<b>Service No.</b> Alum dosing sys (pumps & 300 Ltr Tank) <b>SAC Code.</b> 9994	EA	1	29,000.00		29,000.00
					CGST @ 9 %	2,610.00
					SGST @ 9 %	2,610.00
100	<b>Service No.</b> All instrumentation, pressure gauge <b>SAC Code.</b> 9994	LOT	1	25,000.00		25,000.00
					CGST @ 9 %	2,250.00
					SGST @ 9 %	2,250.00
110	<b>Service No.</b> Centrifuge & feed pumps as per data sheet <b>SAC Code.</b> 9994	EA	1	230,000.00		230,000.00
					CGST @ 9 %	20,700.00
					SGST @ 9 %	20,700.00
120	<b>Service No.</b> Ozonation system for disinfection 100 % <b>SAC Code.</b> 9994	EA	1	352,000.00		352,000.00
					CGST @ 9 %	31,680.00
					SGST @ 9 %	31,680.00
130	<b>Service No.</b> Sludge recirculation Pumps as per data <b>SAC Code.</b> 9994	EA	3	120,000.00		360,000.00
					CGST @ 9 %	32,400.00
					SGST @ 9 %	32,400.00

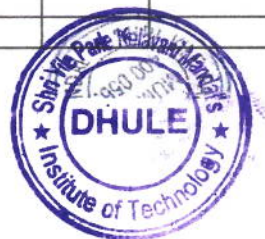



**Shri Vile Parle Kelavani Mandal's**  
 SVKM Central Office-Dhule  
 SVKM's NMIMS  
 Survey No. 499, Near Gurudwara,  
 Behind Hotel Zankar Palace,  
 Dhule 424001

Tel. No. : 022-42335166  
 Fax No. :  
 Email : florenca.dsouza@svkm.ac.in  
 PAN No. : AABTS8228H  
 GST No. : 27AABTS8228H1Z8

**Work Order**

Page 3 of 5

<b>Vendor : 502671</b> PRABHU ENVIROTEC PVT LIMITED 213 / 218, New Apollo Estate Mogra Road Andheri (East) Mumbai 400069 Maharashtra Tel. No. : 022 - 28380534 GST No. : 27AAACP2328R1Z1	<b>PO No. : 8000003058</b> PO Date : 12.04.2019 Your Reference : Project : NMIMS University at Dhule WBS : S-D.01.02.04.05.09 Network : 5000100/0640	<b>Delivery Address :</b> Dhule University         <b>Total Amt : INR 7,552,000.00</b>
--	---	--

140	<b>Service No.</b> Power & ctrl panel, power & ctrl cabling <b>SAC Code.</b> 9994	LOT	1	500,000.00		500,000.00
					CGST @ 9 %	45,000.00
					SGST @ 9 %	45,000.00
150	<b>Service No.</b> Ultrafiltration system <b>SAC Code.</b> 9994	EA	1	1,850,000.00		1,850,000.00
					CGST @ 9 %	166,500.00
					SGST @ 9 %	166,500.00
160	<b>Service No.</b> All interconnecting piping, Valves, accs <b>SAC Code.</b> 9994	LOT	1	360,000.00		360,000.00
					CGST @ 9 %	32,400.00
					SGST @ 9 %	32,400.00
170	<b>Service No.</b> Earthing <b>SAC Code.</b> 9994	LOT	1	30,000.00		30,000.00
					CGST @ 9 %	2,700.00
					SGST @ 9 %	2,700.00

**Amt. in words :** Rupees Seventy Five Lakh Fifty Two Thousand Only **Total : 7,552,000.00**

<b>Commercial Terms &amp; Conditions :</b>  Payment terms : Payable on or After 30 days of Delivery  Inco Terms : Free Dely.at Institute  Warranty :  AMC Period : To	Delivery Address:SVKM's PRIVATE UNIVERSITY, DHULE CAMPUS(University Building)Survey No. 499,Near Gurudwara, Behind Hotel Zankar Palace,Mumbai Agra Highway No.03,Dhule, Dist Dhule,Maharashtra, Pin Code- 424 001Mr.Ishwar Patil- 9823191773
---	--

*Shri Vile Parle Kelavani Mandal's*  
18/4





**Shri Vile Parle Kelavani Mandal's**  
SVKM Central Office-Dhule  
SVKM's NMIMS  
Survey No. 499, Near Gurudwara,  
Behind Hotel Zankar Palace,  
Dhule 424001

Tel. No. : 022-42335166  
Fax No. :  
Email : florencia.dsouza@svkm.ac.in  
PAN No. : AABTS8228H  
GST No. : 27AABTS8228H1Z8

**Work Order**

Page 4 of 5

<b>Vendor : 502671</b> PRABHU ENVIROTEC PVT LIMITED 213 / 218, New Apollo Estate Mogra Road Andheri (East) Mumbai 400069 Maharashtra Tel. No. : 022 - 28380534 GST No. : 27AAACP2328R1Z1	<b>PO No. : 8000003058</b> PO Date : 12.04.2019 Your Reference : Project : NMIMS University at Dhule WBS : S-D.01.02.04.05.09 Network : 5000100/0640	<b>Delivery Address :</b> Dhule University  <b>Total Amt : INR 7,552,000.00</b>
--	---	--

**AMC Service Conditions :**

**Details of Installation and Commissioning :**

**Penalty for Breach of Contract:**

**Any Other terms :** All other terms and conditions are as per our Work Order No.SVKM/VO/DHULE  
PROJ/2019/13

**General Terms & Conditions Overleaf**





**Shri Vile Parle Kelavani Mandal's**  
SVKM Central Office-Dhule  
SVKM's NMIMS  
Survey No. 499, Near Gurudwara,  
Behind Hotel Zankar Palace,  
Dhule 424001

Tel. No. : 022-42335166  
Fax No. :  
Email : florenca.dsouza@svkm.ac.in  
PAN No. : AABTS8228H  
GST No. : 27AABTS8228H1Z8

**Work Order**

Page 5 of 5

<b>Vendor : 502671</b> PRABHU ENVIROTEC PVT LIMITED 213 / 218, New Apollo Estate Mogra Road Andheri (East) Mumbai 400069 Maharashtra Tel. No. : 022 - 28380534 GST No. : 27AAACP2328R1Z1	<b>PO No. : 8000003058</b> PO Date : 12.04.2019 Your Reference : Project : NMIMS University at Dhule WBS : S-D.01.02.04.05.09 Network : 5000100/0640	<b>Delivery Address :</b> Dhule University  <b>Total Amt : INR 7,552,000.00</b>
--	---	--

**Terms & Conditions : ---**

- 1) Please quote the PO no., Vendor no. on all Invoices & Challans
- 2) All the Goods are to be supplied strictly in accordance with description and specifications given.
- 3) The time quoted for delivery of Goods / completion of Services are to be strictly adhered to. This PO is liable to cancellation, if delivery is not effected by the due date.
- 4) Price quoted by Supplier and accepted by us are final and no deviation therefrom will be accepted without our specific agreement in writing.
- 5) Any dispute arising out of this injury shall be deemed to have been arisen in Mumbai and is subject to adjudicated to the - Mumbai Court.
- 6) All the deliveries of Goods and its installation, if required, will be free to the point of delivery address, unless installation payments are expressly agreed mutually.
- 7) The supplier will provide the necessary original certification, if required by the Buyer without any escalation of price of Goods/ services.
- 8) PO placed for Works Contract will attract GST as per GST Act 2017.
- 9) All the Invoices submitted must bear PAN No and GST No provided by council.
- 10) Vendor will comply with all the necessary applicable labour laws, including but not limited to PF, ESIC, Workmen's Compensation Act etc. at all times and hold us indemnified from any action under such laws, for any default committed by you in the execution of this order.

Prepared & Checked by

Advisor to President

Director - Project Imp. & Admin.

PO / WO No : 3058

For and on behalf of

Shri Vile Parle Kelavani Mandal

Authorised Signatory

Jagdish B. Patikh



Prabhu Envirotech Pvt Ltd.

Project Name: NMIMS CAMPUS DHULE University.		SVKM	
Client: SVKM			
Title: STP Package			
PRICE SUMMARY		AMOUNT	
1.0	STP Work	Rs.	6,400,000.00
	TOTAL	Rs.	6,400,000.00
	TAXES @ 18% GST ON TOTAL		1,152,000.00
	GRAND TOTAL		7,552,000.00
2.0	Operating in DLP (24x7) per month	Rs.	2,166,102.72
2.1	Chemical & consumables charges operating during DLP (24x7) per month	Rs.	500,725.80
	Taxes Extra as applicable		

*[Signature]*

~~5-3808~~  
5-3826

PO: 8-3058  
12/04/19

Dhule.

PO value.

- 75,52,000.

Budget.

- 37,00,000.

(36,00,000) reqd.



**SCHEDULE OF WORK**

Item No.	Pay Unit	Description	Qty.	Rate	Total Amount
1.0	Job	Supply, installation, testing and commissioning of MBBR Sewage Treatment Plant of 600KLD capacity Raw sewage to be processed in 20 hours operation per day. (Plant to have 2 Modules of 300 KLD each)	1 Set		
		i) Perforated SS Screen with grease trap , SS 304 Fine screen manual with 6mm holes	1	23,000	23,000
		ii) Raw sewage pumps as per data sheet STP - RSP	3	93,000	279,000
		iii) Diffused aeration system for Equalisation tank , MBBR tank and Sludge Tank complete with blower, piping & diffusers as per data sheet STP - BL	Lot	800,000	800,000
		iv) MBBR Media	Lot	625,000	625,000
		v) Tube settlers for secondary clarifier	Lot	120,000	120,000
		vi) Filter Feed Pumps as per data sheet STP - FFP	3	69,000	207,000
		vii) Pressure Sand Filter as per data sheet STP - PSF	1	300,000	300,000
		viii) Activated carbon Filter as per data sheet STP - ACF	1	310,000	310,000
		ix) Alum dosing system (pumps & 300 Litre Tank) as per data sheet STP - DO	1	29,000	29,000
		xi) Hypochlorite dosing system (pumps & 300 Litre Tank) as per data sheet STP - DO	QRO	30,000	
		xii) All instrumentation, pressure gauge	Lot	25,000	25,000
		xiii) Centrifuge and feed pumps as per data sheet STP - CP	1	230,000	230,000
		xiv) Ozonation system for disinfection for 100% capacity - OZ	1	352,000	352,000
		xv) Sludge recirculation Pumps as per data sheet STP - SRP	3	120,000	360,000
		xvi) Power & control panel, power and control cabling from panel to equipment	Lot	500,000	500,000
		xvii) Ultrafiltration system	Set	1,850,000	1,850,000
		xviii) All interconnecting piping, Valves, accessories with in the plant room and painting of all equipment	Lot	360,000	360,000
		xviii) Earthing	Lot	30,000	30,000
		xix) Softner with feed Pumps	QRO	545,000	
		<b>Total of 1.0</b>			<b>6,400,000</b>
		<b>Note:</b>			
		DLP for 3 years after Project completion (Comprehensive)			
2.0		Vendor to specify operating charge in DLP (24x7) per month			
		Year 1 Rs / month .....	12	58,400	700,800
		Year 2 Rs / month .....	12	60,152	721,824
		Year 3 Rs / month .....	12	61,957	743,479
		<b>Total of 2.0</b>			<b>2,166,103</b>
2.1		Vendor to specify chemical & consumables charges operating during DLP (24x7) per month			
		Year 1 Rs / month .....	1	162,000	162,000
		Year 2 Rs / month .....	1	166,860	166,860
		Year 3 Rs / month .....	1	171,866	171,866
		<b>Total of 2.1</b>			<b>500,726</b>



**CHECK LIST FOR PREPARATION OF PURCHASE ORDER**

Vendor Name: Pradhy Enivotec Pvt Ltd

PO Date: 15/4/19

**A-I Data & Document Requirement for Creation of a Material-Purchase Order:**

- Check the Performa Invoice/Quotation with **Authorised Signature**.
- Check the **Project Name** whether exists in PS System?
- Check whether the Performa Invoice/Quotation contains HSN code or not
- Put name & date of the person who has submitted the Invoice/Quotation for raising PO.

**A-II Process to Create a Purchase Order:**

- First check the **Budget** availability for the Project (S\_ALR\_87013558)
- Now fix the **Material Code** which to be used to create PO (ZMM60)
- Check the availability of the **Material Code** in the Plant where to raise the PO
- Check the Batch/ Requirement specification else create new (MSC1N)
- Now raise the Purchase Requisition then Fix the vendor accurately.
- In Vendor Master Check GST No (XK03) & Match it with the GST No mentioned in the Pl.
- Now raise the PO.

**B-I Data & Document Requirement for Creation of a Service-Purchase Order (WO):**

- Check the Performa Work Order with **Authorised Signature**.
- Check whether the Manual Work Order has contains **OB Approval**?
- Check the **Project Name** whether exists in PS System?
- Check whether the Performa Invoice/Quotation contains **SAC** code or not.
- Put name & date of the person who has submitted the Invoice/Quotation for raising PO.
- In Vendor Master Check GST No.(XK03) & Match it with the GST No mentioned in the Pl.
- Check if the PO is already prepared in SAP.
- Now raise the PO.

Is this PO is Prepared for the 1<sup>st</sup> time or is by deleting Old PO? 1<sup>st</sup> time

Is this Variation PO? if Yes then mention the Original PO No. \_\_\_\_\_

*[Handwritten Signature]*

Checked & Prepared By

